

KEY

- 1 Existing vegetation
- 2 Mixed native hedge at the road junction set back from visibility splays
- 3 Bulbs within the verges to both sides of the access road
- 4 Supplement existing vegetation between Colwell Farmhouse and the entrance road with new trees and shrubs to reduce visibility

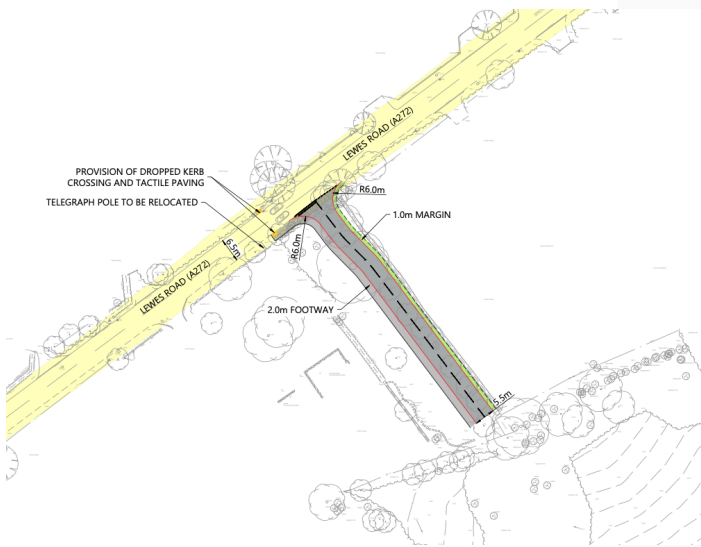

Site access onto Lewes Road



Site access (enlarged)

The proposed site access on Lewes Road (A272) lies between North Colwell Farmhouse and number 90 Lewes Road. Some existing vegetation and trees will need removal but will be replaced with tree planting and hedging to blend the landscape.

The proposal includes a pedestrian crossing on Lewes Road near the site access (uncontrolled and controlled signal options are being explored) to enhance safety for pedestrians. This crossing links the site to the existing northern footway and onwards to existing Footpaths via the Public Right of Way network providing access towards local facilities and Northlands Wood Primary Academy School. Feedback on this crossing will support ongoing discussions with West Sussex County Council highways officers and can be submitted via the feedback form.

The design of the site will ensure that adequate parking and cycle facilities are provided for residents and visitors.



NORTH COLWELL FARM

making our homes,
our workplaces and
the wider environment
a better place